

**B1 ASSEMBLY DRAWING**

IF THIS DOCUMENT IS PRINTED IN HARD COPY, IT IS FOR INFORMATION USE ONLY AND THEREFORE IS NOT SUBJECT TO UPDATING CONTROLS. ALWAYS REFER TO SOLIDWORKS VIEWER FOR LATEST ISSUE



THIS DRAWING IS CONFIDENTIAL AND IS SUPPLIED ON THE EXPRESS CONDITION THAT IT SHALL NOT BE LOANED OR COPIED OR DISCLOSED TO ANY OTHER PERSON OR USED FOR ANY OTHER PURPOSE WITHOUT THE WRITTEN CONSENT OF AP RACING LTD.

**AP RACING**  
 AP Racing  
 Wheler Road  
 Coventry  
 CV3 4LB  
 Tel: +44 024 7663 9595  
 Fax: +44 024 7663 9559  
 e-mail: sales@apracings.co.uk  
 Web site: HTTP://www.apracings.com  
 © AP Racing Ltd. 2016

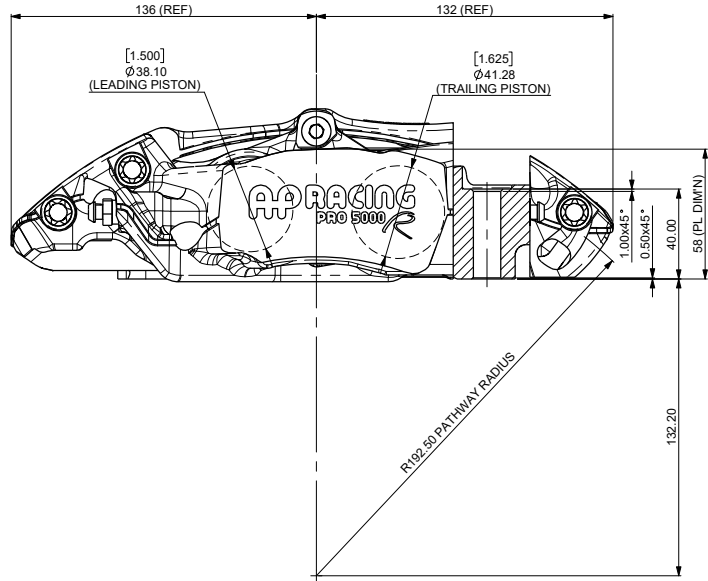
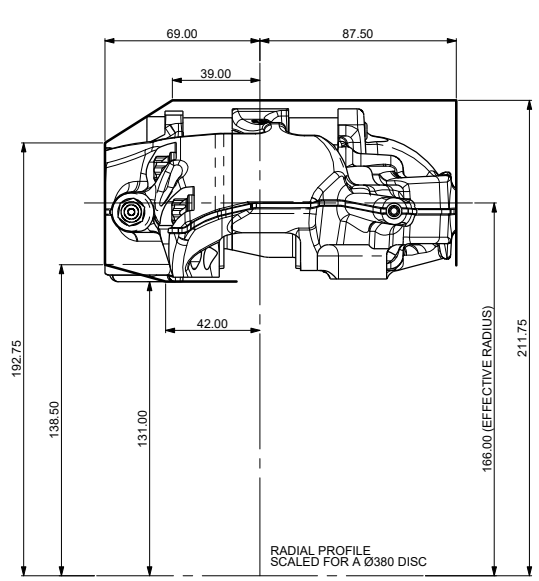

**GENERAL DESCRIPTION**  
 THIS 4 PISTON DIFFERENTIAL BORE CALIPER TO SUIT UP TO Ø380 IRON DISC WITH A THICKNESS OF 28-32mm.

**APPLICATION**  
 GENERAL USE CALIPER.

**TECHNICAL INFORMATION**  
 TOTAL PISTON AREA: 49.4cm<sup>2</sup>  
 BODY MATERIAL: ALUMINIUM ALLOY  
 PISTON MATERIAL: STAINLESS STEEL

ASSEMBLY WEIGHT (LESS PADS): 2.24Kg

MINIMUM DISC & PAD STACK: 40MM

**INSTALLATION INFORMATION**  
 DISC & CALIPER MOUNTING TOLERANCES TO BE SUCH THAT THE DISC IS CENTRAL TO THE CALIPER TO WITHIN ±0.5mm  
 DISC DIAMETRAL CLEARANCE SHOULD BE 2.5mm NOMINAL FROM DISC Q/D TO PATHWAY.

**KEY TO DIMENSIONS**  
 'PL' DIMN : TOP OF PAD MATERIAL TO MOUNTING FACE.  
 'U' DIMN : WHEEL CENTRE LINE TO CALIPER MOUNTING FACE = (DISC Ø/2) - PL DIMN

AP RACING TECHNICAL SECTION WILL BE PLEASED TO ADVISE ON THE MOST SUITABLE EQUIPMENT FOR ANY PARTICULAR APPLICATION.

**CALIPER PART NUMBERS**  
 CP9448-2S4L - RIGHT HAND  
 CP9448-3S4L - LEFT HAND

**RECOMMENDED DISC AND PAD OPTIONS AVAILABLE**  
 D46 DISC AND PAD COMBINATION

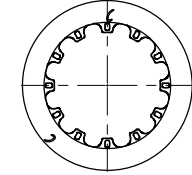

- CP5772-1010/1GA Ø378x32 12F 72V 6.26Kg
- CP5914-116/7G12 Ø378x28 12B 48V 6.20Kg
- CP5914-110/1G8 Ø378x28 12F 48V 6.28Kg

SEE CUSTOMER DRAWING FOR FULL DETAIL

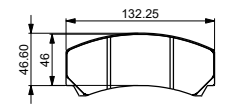

**CP3215D46 PAD FAMILY**  
 PAD THICKNESS - 16.75mm  
 PAD AREA - 50.89cm<sup>2</sup>  
 PAD VOLUME - 85.24cm<sup>3</sup>

**OPTIMUM BLEED POSITIONING**

FOR OPTIMUM BLEED, THE CALIPER SHOULD BE INSTALLED IN THE LEADING OR TRAILING POSITION BETWEEN THE ANGLES SHOWN

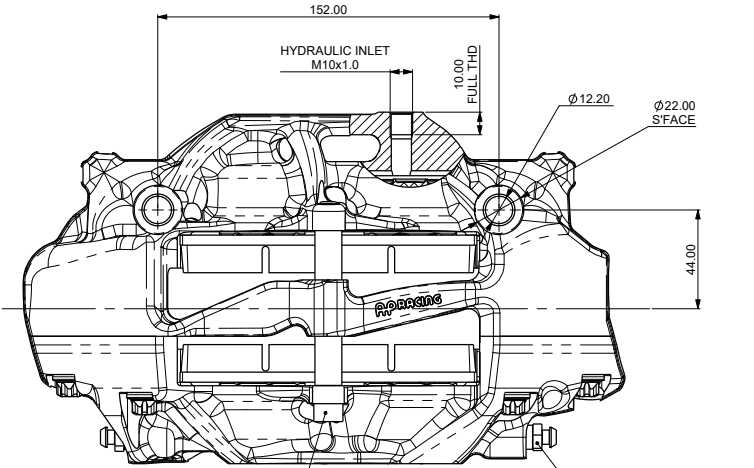
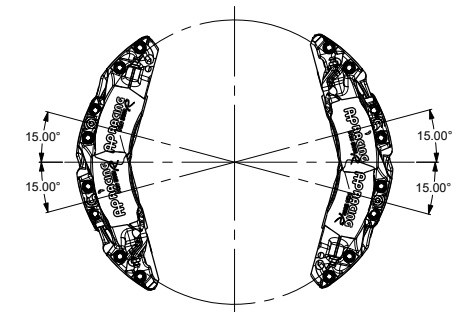

PAD RETAINING BOLT SHOULD BE TIGHTENED TO A TORQUE OF 19Nm (14lb ft)

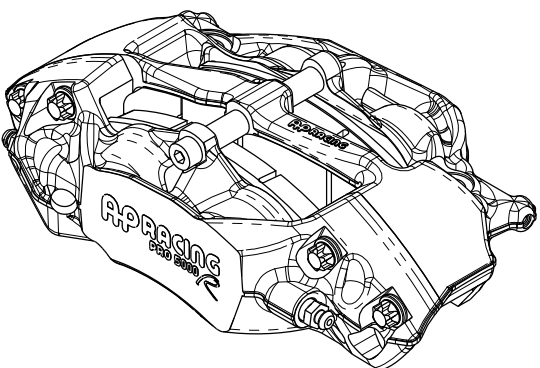

REV	Alterations			
	Date & No.	Particulars	Zone	Initials
1A	15/09/16 87476	FIRST ISSUE		NJS
1B	17/07/2017 B7726_01	CHANGED TORQUE SPECIFICATION NOTE	C10	SGW
1C	22/08/23 RAC23531	SHEET 2 AXB SPRINGS ADDED TO SPARES TABLE AND MODEL	K10	HMB

SCALE 1:1	SHEET 1 OF 2
DRAWN N STEVENS	
APPROVED	
DERIVED FROM	
TITLE 4 POT PRO5000 R CALIPER INSTALLATION	
DRG NO.	CP9448-1CD

**B1 ASSEMBLY DRAWING**

IF THIS DOCUMENT IS PRINTED IN HARDCOPY, IT IS FOR INFORMATION USE ONLY AND THEREFORE IS NOT SUBJECT TO UPDATING CONTROLS. ALWAYS REFER TO SOLIDWORKS VIEWER FOR LATEST ISSUE



THIS DRAWING IS CONFIDENTIAL AND IS SUPPLIED ON THE EXPRESS CONDITION THAT IT SHALL NOT BE LOANED OR COPIED OR DISCLOSED TO ANY OTHER PERSON OR USED FOR ANY OTHER PURPOSE WITHOUT THE WRITTEN CONSENT OF AP RACING LTD.



**AP Racing**  
Wheler Road  
Coventry  
CV3 4LB  
Tel: +44 024 7663 9595  
Fax: +44 024 7663 9559  
e-mail: sales@apracings.co.uk  
Web site: HTTP://www.apracings.com

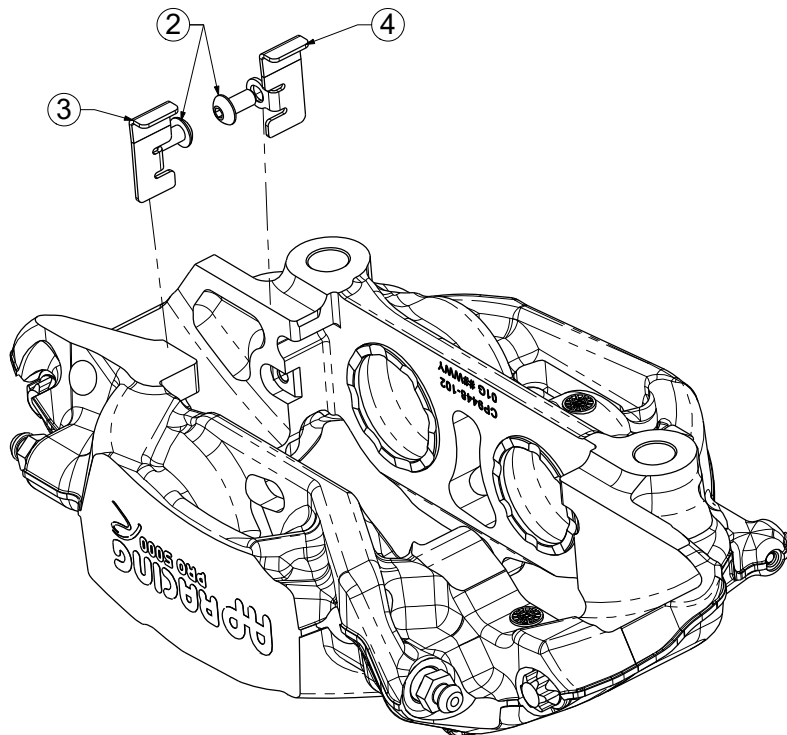

REF	PART NUMBER	DESCRIPTION	QTY / CALIPER	FITTING NOTES
1	CP3880-1	M10 BLEED SCREW KIT	2	TIGHTENING TORQUE - 17Nm
2	CP9440-116	M5 BUTTON SCREW	2	APPLY A 1-2MM DROP OF LOCTITE 270 TO THE 2ND FROM LAST THREAD WHEN FITTING. TIGHTENING TORQUE - 3.7Nm
3	CP9444-112	RH WEARPLATE	1	APPLY 736 RTV SILICONE SPARINGLY BEHIND THE ABUTMENT PLATE ENSURING ENTIRE CONTACT FACE IS COVERED.  APPLY PRESSURE TO ABUTMENT PLATE WHEN FITTING TO ENSURE MINIMUM FILM THICKNESS AND AVOID ANY GAP.
4	CP9444-113	LH WEARPLATE		ENSURE ABUTMENT PLATE SITS CORRECTLY AGAINST CALIPER BODY BEFORE FITTING RETAINING SCREW.
5	CP9445-109	Ø1 1/2" SST PISTON	2	
6	CP9444-111	Ø1 5/8" SST PISTON	2	
7	CP8518-JK	PISTON SEAL KIT	1	REFER TO PUBLICATION REF: P14.290 & P14.220
8	CP3596-112ST	M8 CAP SCREW	1	TIGHTENING TORQUE - 13.1Nm
9	CP9440-110	PAD RETAINER TUBE	2	
10	CP6518-4LBLL	4lb AKB SPRING KIT	1	

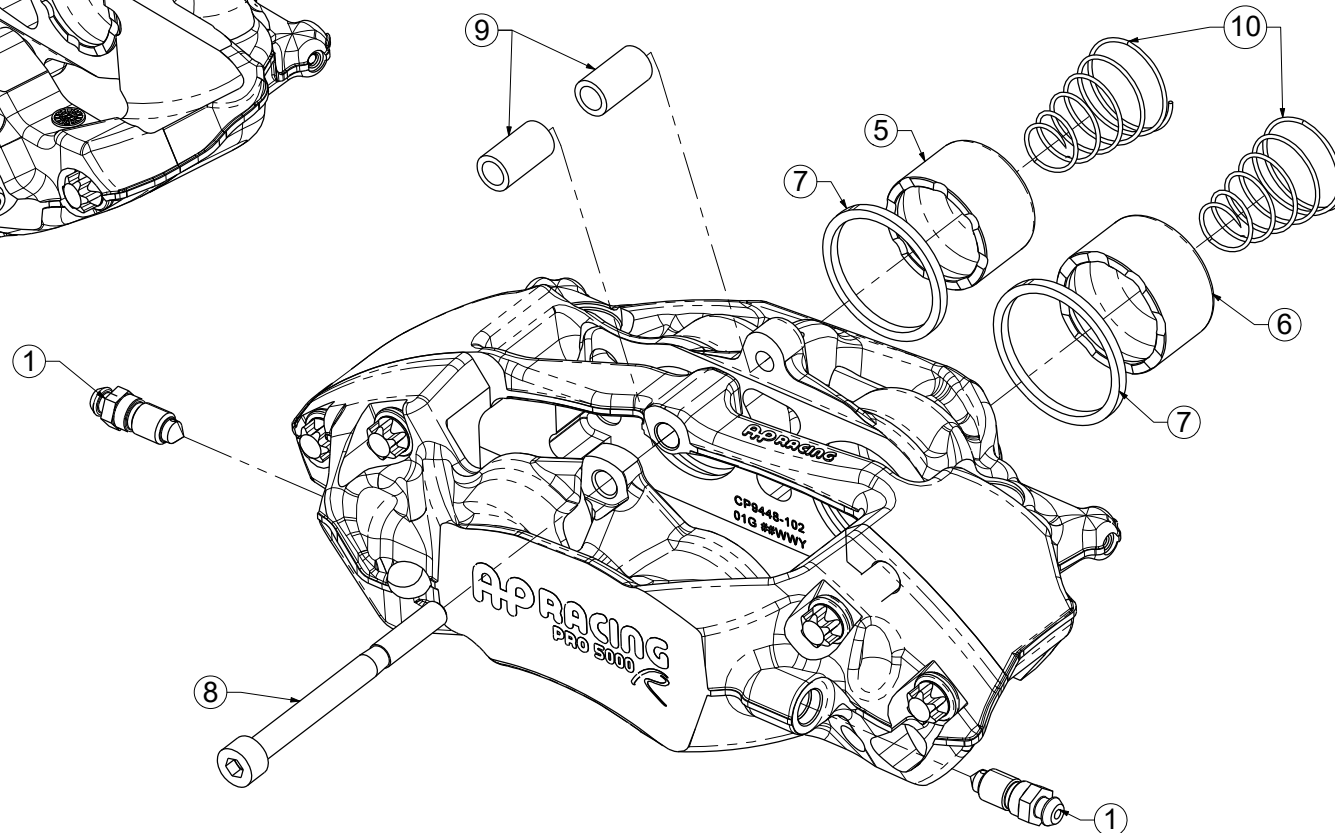

Rev	Alterations		
	Date & No.	Particulars	Zone / Initials
1		SEE SHEET 1 FOR ISSUE INFORMATION.	

SCALE 1.5:1	SHEET 2 OF 2
DRAWN	N STEVENS
APPROVED	
DERIVED FROM	
TITLE	
DRG NO.	CP9448-1CD